

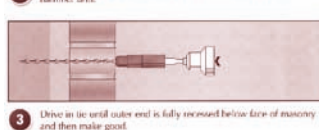

## Remedial Wall Tie Systems

### DryFix - Dry Mechanical Pinning & Remedial Tying System

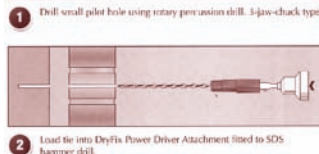
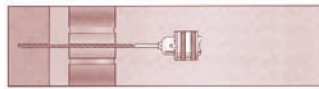
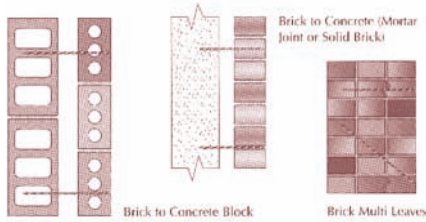

#### Technical Data

##### Size (length)

No.8 x 195mm

No.8 x 220mm

No.8 x 245mm

#### Advantages

- Replacement wall tie
- For securing multiple layers of masonry .
- For pinning delicate masonry features

#### Features & Benefits

- Self-tapping, secure, stress-free fixing
- Requires no resin, grout or mechanical expansion
- Highly economical with low installed costs.
- Slim, one-piece, grade 316 stainless steel tie
- Extremely quick and easy to install
- Effective in bricks, blocks, concrete, hard mortar, timber
- Effective in cavity and solid walls and close to edges
- Usable in all weathers, temperatures and environments
- Great tensile strength.
- Flexibility accommodates normal building movement
- Multiple drip points prevent cross cavity transfer of water
- Can be installed through insulation
- Leaves masonry virtually unmarked
- Minimal inconvenience to occupants

### ResiTie - 6mm Remedial Wall Tie with a Resin / Resin Fix

Replacement tie for cavity walls where a resin bond is required at both ends of the tie. Recommended for small jobs requiring 200 ties or less.

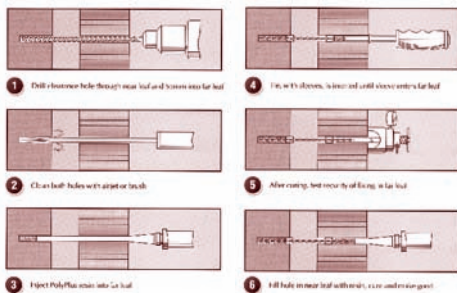

#### Technical Data

##### Size (length)

No.6 x 195mm

No.6 x 220mm

No.6 x 245mm

#### Features

- One-piece grade 304 or 316 stainless steel tie
- Quick and easy installation
- Four standard lengths for cavities up to 140mm
- Effective in all common building materials
- Rotational flexibility accommodates building movement

#### Benefits

- Highly economical and effective
- Minimal inconvenience to occupants
- Leaves building virtually unmarked
- No splitting of bricks or blocks
- Far leaf security of fixing easily tested
- No special tools; ideal for smaller applications
- Multiple drip points prevent transfer of water across cavity



## Crack Stitching System

### Helibar Crack Stitching - Fast, Simple & effective

where cracks are less than 500mm from an external corner (A) or an opening (B) at least 100mm should be bent round the corner and bonded into the return wall or bent and fixed into the reveal, avoiding any DPC membrane.

Cross sections of solid wall and cavity wall showing Helibar rod installed.

Dryfix remedial wall ties may be required for additional stability



#### Features & Benefits

- Austenitic stainless steel reinforcing bars
- Fully concealed, non-disruptive repair system
- Cost-effective and more reliable than crack injection methods
- HeliBond cementitious grout is injectable & high compressive strength
- HeliBar rods and grout produce excellent bond strength
- HeliBars combine great axial strength with flexibility .
- No additional stresses introduced
- Tensile loads redistributed along the masonry
- Masonry remains flexible enough to accommodate building movement
- Minimises chances of the crack developing

#### Technical Data

##### Size (length)

6mm x 1000mm

6mm x 1500mm

### Helibond Grout

High Performance, injectable, cementitious grout for bonding metal components into masonry type substrates.



#### Technical Data

1.5 Litre Tub

3.0 Litre Tub

Pointing Gun Kits

Mortar Nozzels

#### Features & Benefits

- Features and Benefits
- Non-shrink thixotropic grout
- Flows easily under pressure to fill voids
- Rapidly develops compressive strength
- Cures within 28 days to reach 80N/mm<sup>2</sup>
- Ready to mix components for use in hand held applicator