

## Continuous HY-Chair & Circular Spacers

### Heavy Duty - Triangular HY-Chair



Heavy Duty hy-chair for supporting both bar and mesh off polythene membrane without the risk of puncture. Can also be used for supporting dowel bars

Size	Pack Size (LM)
50mm x 2m	25
60mm x 2m	25
75mm x 2m	25
90mm x 2m	25
105mm x 2m	25
120mm x 2m	25
135mm x 2m	25
150mm x 2m	25
170mm x 2m	25

### Standard Duty - Flat Top HY-Chair



Standard Duty hy-chair for supporting both bar and mesh off polythene membrane without the risk of puncture. Can also be used for supporting dowel bars

Size	Pack Size (LM)
50mm x 2m	25
60mm x 2m	25
75mm x 2m	25
90mm x 2m	25
105mm x 2m	25
120mm x 2m	25
135mm x 2m	25
150mm x 2m	25
170mm x 2m	25

### Circular Spacers

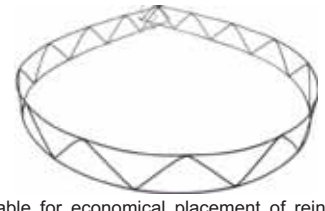

Suitable for economical placement of reinforcement mesh in floor slabs. A 3.0 metre strip which is formed to a circle on site. 3 or 4 strips are required per sheet of mesh.

Size	Pack Size (Each)
50mm x 3m	20
60mm x 3m	20
75mm x 3m	20
90mm x 3m	20
105mm x 3m	20
120mm x 3m	20
135mm x 3m	20
150mm x 3m	20
170mm x 3m	20

Hy-chairs and circulars are available in sizes of up to 300mm upon request.

## Tying Wire, Dowel Bar Cradles & Tools

### Tying Wire - Black Annealed



A 16 gauge soft black annealed tying wire supplied in coils for steel fixing.

Size	Pack Size (LM)
2kg	Coil
15kg	Coil
20kg	Coil

### Tying Wire - Stainless Steel



An 18 gauge stainless steel tying wire supplied in catchweight coils.

Size	Pack Size (LM)
2kg	Coil
15kg	Coil
20kg	Coil

### Tying Wire Tools



An alternative to tying wire wrap the tie around the reinforcement bar with the tying tool



Description	Size
Double Loop Ties	100/120/150/200/250 & 300mm Lengths
Ratchet Tying Tool	Each
Cutting/Tying Snips	Each

### Contraction Joint Cradle

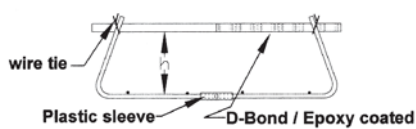

Slab Depth	Dim to u/s Dowel
150 - 180mm	75mm
190 - 230mm	95mm
240 - 300mm	125mm

### Expansion Joint Cradle

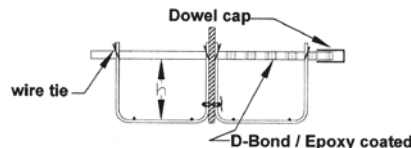

Slab Depth	Dim to u/s Dowel
150 - 180mm	65mm
190 - 230mm	90mm
240 - 300mm	115mm

Joint cradles are for supporting dowel bars in contraction and expansion joints.

### BindFix - Spring Clip Fixing Ties



An alternative to tying wire easy to use, bind clip ties require not cut-offs or tools.

Type	to Bind Bars Sizes	Pack Size
BF8/8	5/8 & 6/8	500
BF8/10	6/8 & 8/10	500
BF8/12	6/10 & 10/12	500
BF8/14	6/8 & 12/14	500
BF8/16	6/10 & 14/16	400
BF8/20	6/10 & 18/20	400



## Reelfix Tying Wire System



Reelfix Rapid is a tying wire dispensing reel system used by Steel Fixers when tying reinforcement in concrete structures. The system comprises of a dispensing reel which houses a 2kg spool of tying wire. The reel is attached to a heavy duty leather belt and comfort pad and is worn around the users' waist.

Reelfix works by allowing the user to draw tying wire from the reel as required. Any excess wire drawn while tying can easily be rewound into the reel where it remains clean, dry and ready until required again.

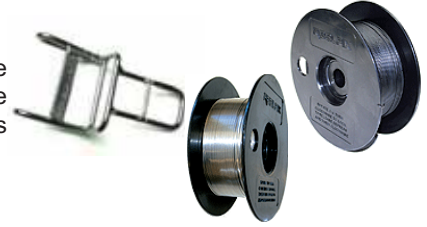

### Advantages

Safety	Eliminates the trip hazard risk associated with the use of loose tying wire.
Waste	Reelfix wire is used 100% with no unused lengths therefore, no waste.
Usage	Ties 50-70% more rebar per kilo of wire than using loose coils.
Health	No unnecessary bending for wire reduces risk of back strain.
Efficiency	Average 8 hours supply of tying wire right where the fixer needs it.
Pre-pour	No unused lengths of wire means super fast pre pour cleaning.

### Reelfix System Components

2kg (140M 17gauge) Black Annealed Refill Spool
2kg (220M 18gauge) Stainless 304 Refill Spool
Refillable Tying Wire Dispensing Reel
Reelfix Branded Heavy Duty Leather Belt
PVC Comfort Pad
Reelfix Branded Stainless Tape/Nip Frog
2kg (120M 16gauge) Black Annealed Disposable Reel
2kg (220M 18gauge) Stainless 304 Disposable Reel

## Plastic Spacers & Accessories

### Grade Plate Spacer



A lightweight option for the spacing of fabric at the bottom of slabs. Their wide base gives extra stability particularly on soft blinding.

Concrete Cover (mm)	Pack Quantity
25/30	250
40/50	250
65/75	200
90/100	100

### Continuous Plastic Spacer (Tric Trac)



Use for bottom spacing of fabric or bar with light loads against formwork and particularly metal decking. Available in 2 metre lengths.

Concrete Cover (mm)	Pack Quantity
15 / 20 / 25	100
30 / 35 / 40 / 50	50

### Wheel Spacer



For spacing vertical reinforcement in columns etc. The wheels clip onto the reinforcement bar and minimise the area of spacer at the form face.

Concrete Cover (mm)	Bar Dia	Quantity
15	4 - 12mm	2000
20 / 25 / 30 / 40 / 50	8 - 12mm	500
25 / 30 / 40 / 50 / 60 / 75	12 - 20mm	250

### Plastic 'A' Clip Spacer



Self clipping bar and mesh spacer, suitable for horizontal or vertical bars. Heavy duty for substantial bar loads.

Cover (mm)	Bar Dia	Quantity
15 / 20	6 - 16mm	1000
25 / 30	8 - 25mm	500
40 / 50	8 - 25mm	250

### Pile Cage Spacer



Designed for pile cages and diaphragm walls. Easily clipped onto helical bars in pile cages.

Cover (mm)	Bar Dia	Quantity
45	8 - 12mm	250
50 / 75	8 - 12mm	250
75	16 - 20mm	100

### HD Plastic Shims



HD plastic shims are used for the alignment and levelling of heavy section steel plate and pre-cast concrete sections. Available as plain or horseshoe type.

Size	Thickness
70mm x 70mm	2 / 3mm (250/pk)
70mm x 70mm	5 / 7 / 9mm (125/pk)

### Safety End Cap



Plastic protection caps for exposed reinforcing bar.

Bar Dia
6 - 18mm
16 - 32mm
40 - 50mm